

Table of Contents:

Important Information	2	Changing the Air Filter	8
Product Contents	2	Notes	8
Installation Instructions	3-7		

IMPORTANT INFORMATION:

Please read these instructions thoroughly before use. Failure to follow instructions may result in equipment damage or failure, losses, injury or death.

⚠ **WARNING:** ⚠

To reduce the risk of electric shock or injury:

- ALWAYS unplug the compressor from power source and remove pressure from airlines before installing the maintenance kit.

IMPORTANT: Airmax® is not responsible for equipment damage or failure, losses, injury or death resulting from failure to follow safety precautions, misuse or abuse of equipment.

PRODUCT CONTENTS:

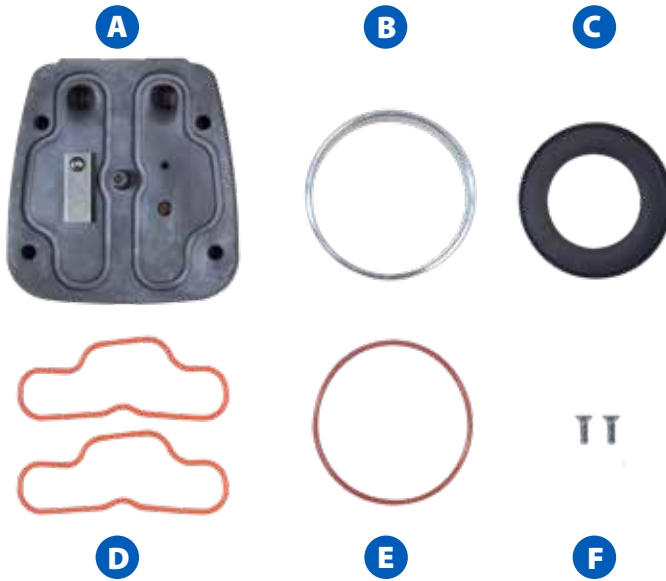

What's Included:

- | | |
|---|-----------------------------|
| A Valve Plate with Pre-Installed Leaf Valves | D 2 Head O-rings |
| B Cylinder Sleeve | E Cylinder O-Ring |
| C Piston Cup | F 2 Torx Head Screws |

INSTALLATION INSTRUCTIONS:



See Video Instructions of the G25 (RP25 87R) Maintenance Kit installation online at airmaxeco.com/InstallRP25

Tools Required:

5/8" Wrench
11/16" Wrench
T25 Torx Wrench
T20 Torx Wrench
Pipe Joint Compound or Teflon Tape



Step 1

Remove the air filter from the valve plate using a 5/8" wrench. Be sure to take note of where the air filter is installed on the valve plate.



Step 2

Using an 11/16" wrench, remove the brass elbow.



Step 3

Using a T25 Torx wrench, remove the four screws on the top of the head assembly.



Step 4

Remove the head assembly and set to the side. Take note of the position of the leaf valve in relation to the capacitor. This positioning will be important when reinstalling the new valve plate. Remove the valve plate and discard.

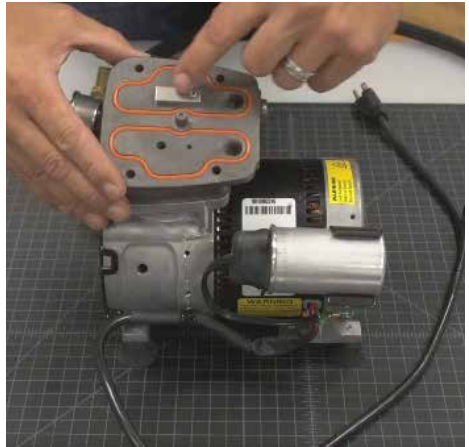

Step 5

Using a T20 Torx wrench, remove the two set screws on the piston retainer plate.



Step 6

Remove the cylinder sleeve and worn piston cup and discard. Place the new piston cup beneath the retainer plate with the lip of the piston cup facing up.

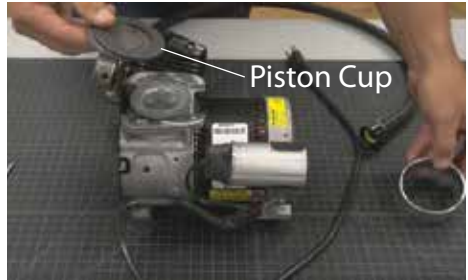

Step 7

Place the retainer plate and piston cup on top of the new piston cylinder sleeve. Firmly push the piston cup into the new cylinder sleeve. Flip over to ensure the piston cup is evenly aligned.

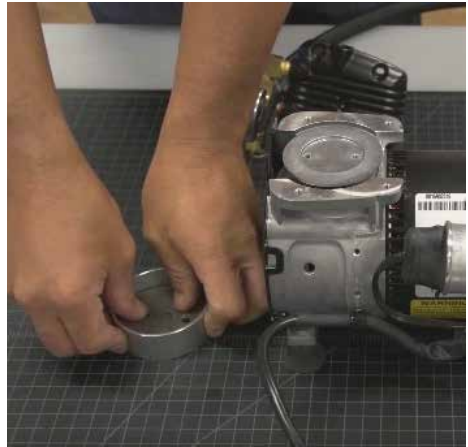

Step 8

Install the cylinder sleeve into the grooves of the compressor body and line up the holes for the piston retainer plate. Use the two screws provided to secure the piston retainer plate (**Recommended Torque: 34-38 in lb**).



Step 9

Flip the new valve plate over to install the new cylinder o-ring.



Step 10

Now install the valve plate onto the cylinder sleeve ensuring the leaf valve is away from the capacitor. Push down firmly to secure in place.



Step 11

Install the two new head o-rings from the maintenance kit into the grooves on the top of the valve plate.

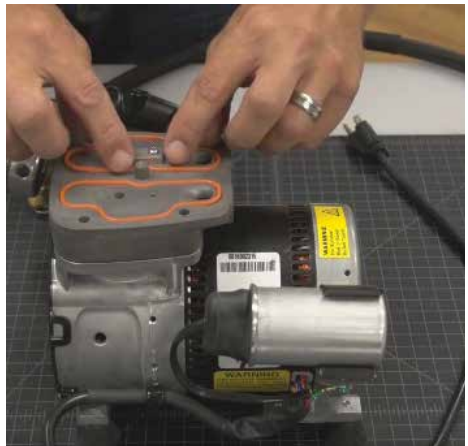

Step 12

Align the head cover on top of the valve plate and install the 4 screws to secure the head cover to the valve plate. We recommend going back and forth between screws to ensure the screws are securely in place. Be sure not to over tighten (**Recommended Torque: 47-50 in lb**).



Step 13

Reinstall the brass elbow for the air filter using an 11/16" wrench. It is recommended to use Pipe Joint Compound or Teflon Tape when reinstalling. Be sure to position the elbow in the upward position.



Step 14

Reinstall the air filter using a 5/8" wrench, again using pipe joint compound.



Changing the Air Filter:



Changing the air filter should be done every 3-6 months

To replace the air filter, hold the base of the air filter and turn the top counterclockwise to remove the air filter cap. Replace the old air filter element with a new one.

NOTES

THANK YOU FOR CHOOSING:

Airmax, Inc.

15425 Chets Way Street
Armada, MI 48005

866-424-7629
www.airmaxeco.com

#510520 V2.1