

INSTALLATION MANUAL

Item #510115

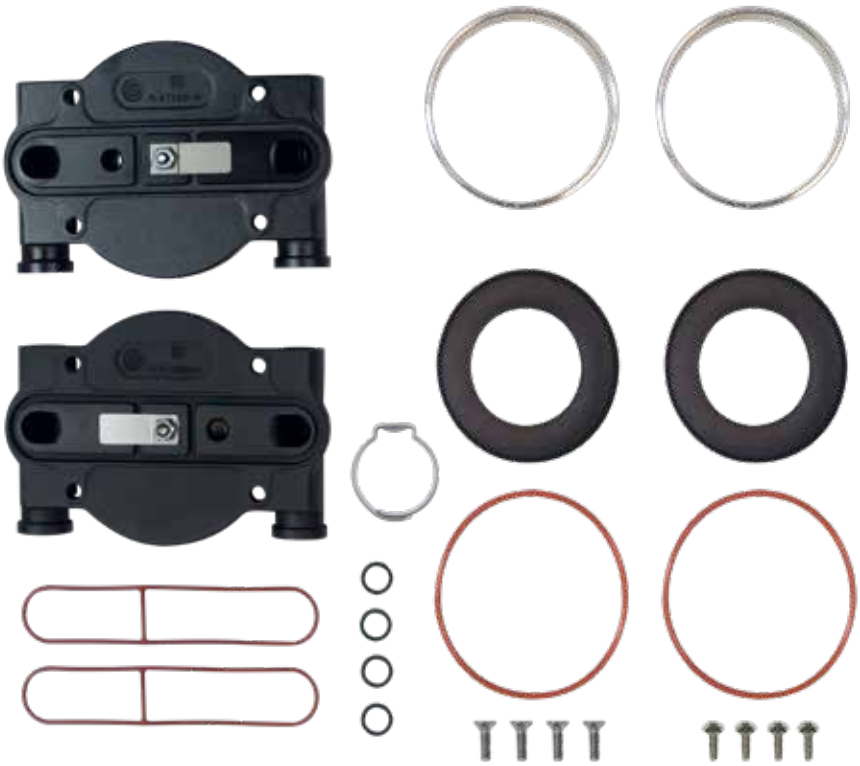

Table of Contents:

Important Information	2	Changing the Air Filter	8
Product Contents	2	Notes	8
Installation Instructions	3-7		

IMPORTANT INFORMATION:

Please read these instructions thoroughly before use. Failure to follow instructions may result in equipment damage or failure, losses, injury or death.

⚠️ WARNING: ⚠️

To reduce the risk of electric shock or injury:

- ALWAYS unplug the compressor from power source and remove pressure from airlines before installing the maintenance kit.

IMPORTANT: Airmax® is not responsible for equipment damage or failure, losses, injury or death resulting from failure to follow safety precautions, misuse or abuse of equipment.

PRODUCT CONTENTS:

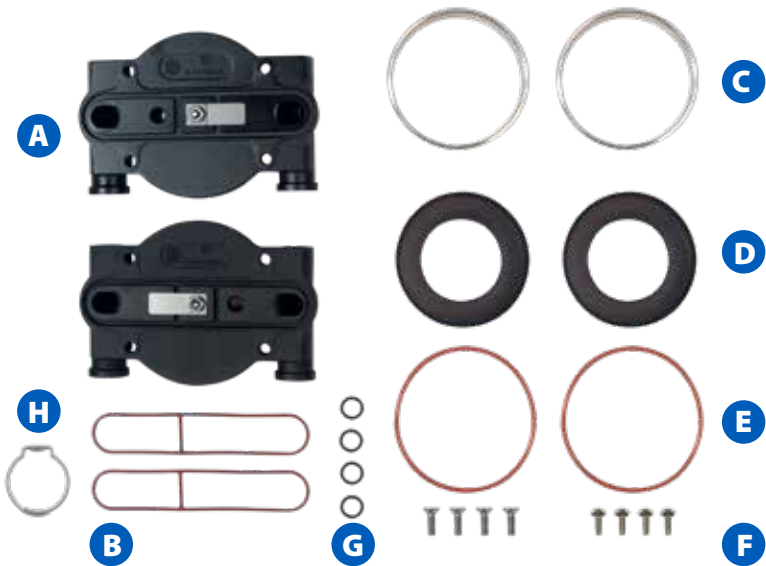

What's Included:

- A** 2 Valve Plates with Pre-Installed Leaf Valves
- B** 2 Head O-Rings
- C** 2 Cylinder Sleeves
- D** 2 Piston Cups
- E** 2 Cylinder O-Rings
- F** 8 Screws (4 have the Torx Head)
- G** 4 Tube O-Rings
- H** Pinch Clamp (Included in case of pinch clamp failure)

INSTALLATION INSTRUCTIONS:

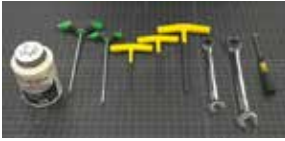

See Video Instructions of the G50 (RP50 72R) Maintenance Kit installation online at airmaxeco.com/InstallRP50

Tools Required:

T25 Torx Wrench
T20 Torx Wrench or
1/8" Allen Wrench
5/32" Allen Wrench
1/4" Allen Wrench

1/2" Wrench
5/8" Wrench
Pick Tool
Pipe Joint Compound or
Teflon Tape

Step 1

Remove the air filter from the valve plate using a 5/8" wrench. Be sure to take note of where the air filter is installed on the valve plate in relation to the capacitor on the compressor.



Step 2

Using a 1/4" Allen wrench, remove the two 1/4" pipe plugs, noting their location on the valve plate.



Step 3

Using a 5/32" Allen wrench, remove the two screws holding down the manifold.



Step 4

Remove and save the two spacers underneath the manifold.



Step 5

Remove the brass 90 degree fitting from the valve plate using a 1/2" wrench. For ease of fitting removal, the pinch clamp and flex tube can be removed from the brass barb.



Step 6

Use a 5/32" Allen wrench to remove the remaining six screws on the top of the head assembly.



Step 7

Separate the heads from the head assembly and set aside. Take note of the positions of the leaf valves in relation to the capacitor. This positioning will be important when reinstalling the new valve plates.

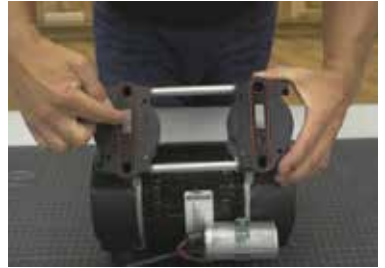

Step 8

Separate the old valve plate from the valve tubes.



Step 9

Remove the tube o-rings with a small pick tool and install the new ones from the maintenance kit. Then firmly place the new valve plate onto the valve tubes.



Step 10

Repeat steps 8 and 9 for the second valve plate and set the valve plate assembly aside.

Step 11

Depending on which screws are installed on your unit, use either a T20 Torx wrench or 1/8" Allen wrench to remove the two set screws on the piston retainer plate for each cylinder.



Step 12

Remove and discard the worn cylinder sleeves and piston cups. Place a retainer plate on top of one of the new piston cups making sure that the lip of the piston cup faces up.



Step 13

Place the retainer plate and piston cup onto the cylinder sleeve. Firmly push the retainer plate into the sleeve. Flip over to ensure the piston cup is evenly aligned.

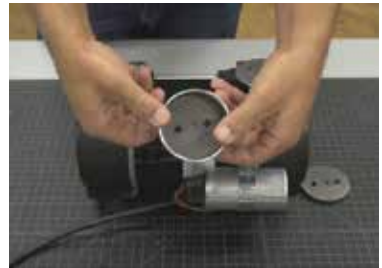

Step 14

Place the cylinder sleeve into the grooves on top of the compressor body and align the retainer plate holes. Use two new screws supplied with the maintenance kit to reinstall the piston cups. Be sure to use the same type of screws that were originally installed on the compressor (**Recommended Torque: 34-38 in lb**).



Step 15

Repeat steps 13 and 14 for the second cylinder.

Step 16

Flip the valve plate over and install the new cylinder o-rings.

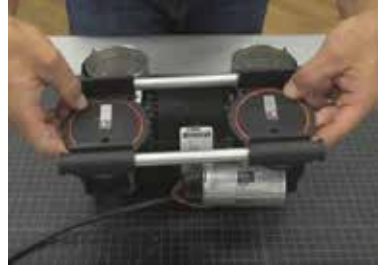

Step 17

Install the valve plate onto the cylinder sleeves ensuring the leaf valves are pointing away from the capacitor. Push down firmly to secure in place.



Step 18

Install the two new head o-rings from the maintenance kit onto the top of the valve plates.



Step 19

Align the head covers on top of the valve plates. Match the grooves in the head to the grooves in the valve plate. Not doing so will damage the leaf valves.



Step 20

Install the six screws to secure the head covers on the valve plates. Leave the inner two screw holes open. We recommend going back and forth between screws to ensure the screws are securely in place. Be sure not to over tighten (**Recommended Torque: 47-50 in lb**).

Step 21

Reinstall the brass 90 degree fitting attached to the manifold hose. If the flex tube was disconnected from the barb, reinstall with the new pinch clamp. It is recommended to use Pipe Joint Compound or Teflon Tape when reinstalling. Be sure to position the 90 degree fitting pointing away from the capacitor and tighten with a 1/2" wrench.

Step 22

Reposition the two spacers onto the two remaining holes in the head assembly. Then reinstall the manifold using the two remaining screws. Tighten down the screws using a 5/32" Allen wrench. Be sure to go back and forth to ensure the screws are securely in place.

Step 23

Reinstall the two 1/2" pipe plugs, using Pipe Joint Compound and a 1/2" Allen wrench. It is important that the plugs are reinstalled in their original valve plate holes.

Step 24

Reinstall the air filter onto the last valve plate hole using a 5/8" wrench, again using pipe joint compound.



Changing the Air Filter:



Changing the air filter should be done every 3-6 months

To replace the air filter, hold the base of the air filter and turn the top counterclockwise to remove the air filter cap. Replace the old air filter element with a new one.

NOTES

THANK YOU FOR CHOOSING:

Airmax, Inc.

15425 Chets Way Street
Armada, MI 48005

866-424-7629
www.airmaxeco.com

#510525 V2.1