



## Table of Contents:

Important Information .....	2	Installation Instructions .....	3-8
Product Contents .....	2	Changing the Air Filter .....	8

## IMPORTANT INFORMATION:

Please read these instructions thoroughly before use. Failure to follow instructions may result in equipment damage or failure, losses, injury or death.

### ⚠ **WARNING:** ⚠

To reduce the risk of electric shock or injury:

- ALWAYS unplug the compressor from power source and remove pressure from airlines before installing the maintenance kit.

**IMPORTANT: Airmax® is not responsible for equipment damage or failure, losses, injury or death resulting from failure to follow safety precautions, misuse or abuse of equipment.**

## PRODUCT CONTENTS:

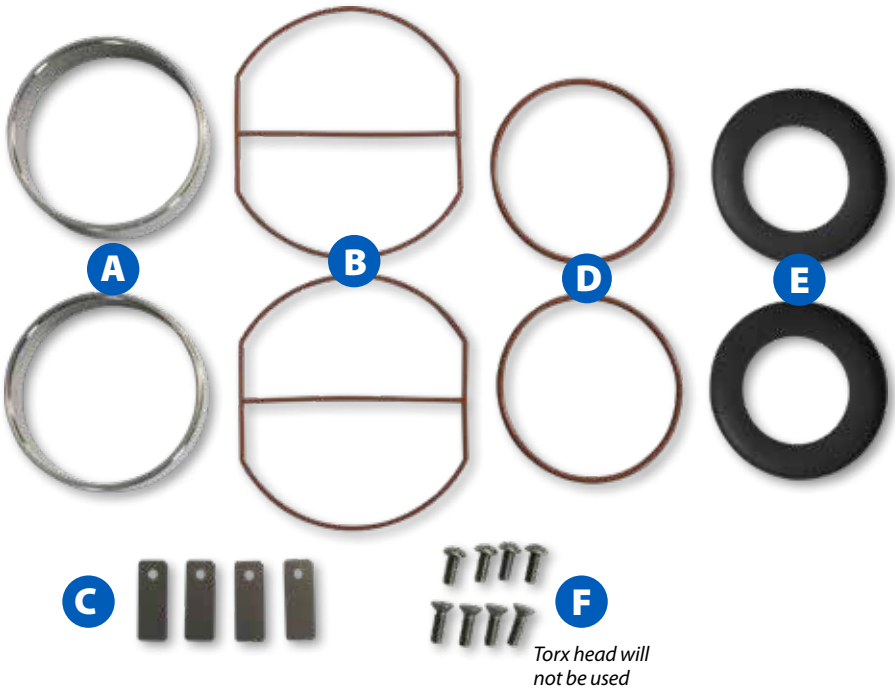

### What's Included:

- A** 2 Cylinder Sleeves
- B** 2 Cylinder Gaskets
- C** 4 Leaf Valves
- D** 2 O-Ring Gaskets
- E** 2 Piston Cups
- F** 8 Screws (The 4 with the Torx head will not be used)



See Video Instructions of the G33 (RP33 82R) Maintenance Kit installation online at [airmaxeco.com/InstallRP33](http://airmaxeco.com/InstallRP33)

## Tools Required:

- 5/32" Allen Wrench
- 1/8" Allen Wrench
- T25 Torx Wrench
- Flathead Screwdriver
- Small Pick Tool
- Heat Source



## Installation Instructions:

### Step 1

Use a 5/32" Allen wrench to remove the two screws holding down the airflow manifold. Remove and save the two bushings underneath the manifold.

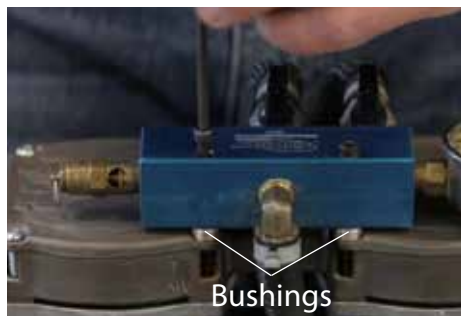

### Step 2

Use a T25 Torx wrench to remove the remaining six screws on the top of the cylinder heads. Take note that the two inner screws are shorter than the outer four screws.



### Step 3

Remove the cylinder heads along with the valve plate and set to the side.



### Step 4

Starting with one cylinder, use a 1/8" Allen wrench to remove the two screws on the piston retainer plate.



### Step 5

Remove and discard the old cylinder sleeve.



### Step 6

Remove and discard the worn piston cup and position the new one beneath the piston retainer plate making sure the lip of the new piston cup faces up.



## Step 7

Place the retainer plate and piston cup on top of the new piston cylinder sleeve. Flip over to ensure the piston cup is properly aligned within the cylinder sleeve.



## Step 8

Install the cylinder sleeve into the grooves of the compressor body and line up the holes for the piston retainer plate. Use two of the new screws provided to secure the piston retainer plate (**Recommended Torque: 34-38 in lb**). Repeat Step 4 thru 8 for the second cylinder before moving on to Step 9.



## Step 9

Use a small pick tool to remove the two o-ring gaskets and two cylinder gaskets from the bottom and top of the valve plate.

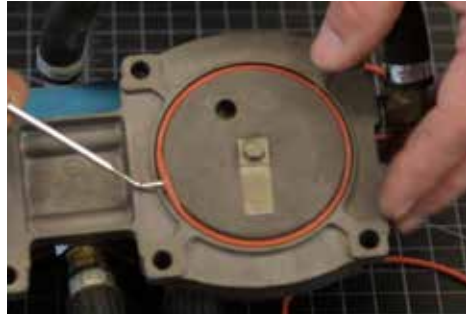

## Step 10

Remove the leaf valves. The leaf valves are originally installed with threadlock. We recommend using a propane torch or other heat source to soften the threadlock before removing the screws. Apply heat for approximately 5-20 seconds and gently remove the screws (Fig. 1). Save the screws but discard the leaf valves (Fig. 2). Repeat this process for all four leaf valves. **NOTE:** On the top leaf valves, also save the valve limiter as this is needed when reinstalling the new leaf valves.



Fig. 1



Fig. 2

## Step 11

Install the new leaf valves. Align the leaf valve over the hole on the valve plate and secure with a set screw. Repeat for the second side. Do not over tighten (**Recommended Torque: 10-13 in lb**).

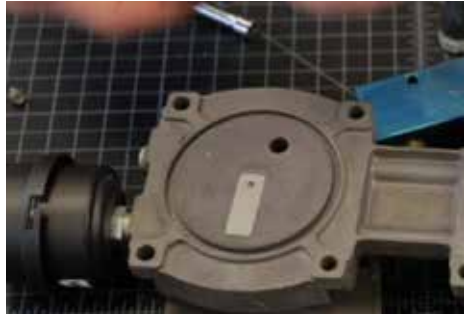

## Step 12

Flip the valve plate over and repeat the process for the other two leaf valves, heating the screws with a propane torch for approximately 5-20 seconds. When installing the top two leaf valves, note to reinstall the valve limiter with the curved portion resting on the leaf valve. Ensure all four leaf valves completely cover the holes (**Recommended Torque: 10-13 in lb**).

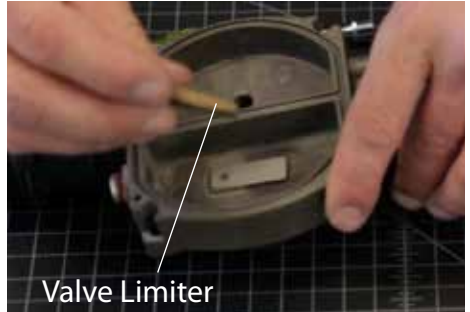

## Step 13

Install the two new o-rings onto the bottom of the valve plate.



## Step 14

Flip the valve plate back onto the cylinder and push down firmly to secure into place.



## Step 15

Install the two new gaskets onto the top of the valve plate.



## Step 16

Install the head cover plates. Align the pins to the holes on top of the valve plate.



## Step 17

Install the four longer screws into the holes along the outside of the compressor. Then install the two smaller screws into the inner holes. Securely tighten all six screws evenly to ensure proper seal (**Recommended Torque: 47-50 in lb**).

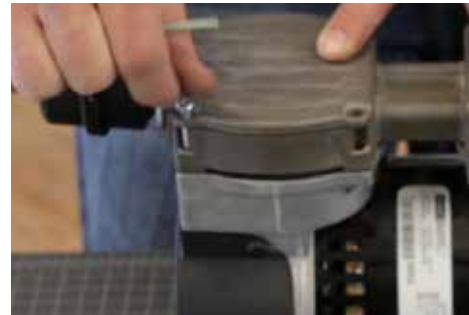

## Step 18

Reapply to two bushings onto the two remaining holes in the cylinder head.



## Step 19

Reinstall the manifold using a 5/32" Allen wrench and the remaining two screws. Tighten the screws firmly to complete the installation (**Recommended Torque: 47-50 in lb**).

Once complete, we recommend to change the compressor air filter.



## Changing the Air Filter:



Changing the air filter should be done every 3-6 months

To replace the air filter, hold the base of the air filter and turn the top counterclockwise to remove the air filter cap. Replace the old air filter element with a new one.

**THANK YOU FOR CHOOSING:**

**Airmax, Inc.**

15425 Chets Way Street  
Armada, MI 48005

866-424-7629  
www.airmaxeco.com

#510523 V2.1